

RFS600

ROTARY FLOATING SHOE VALVES

BULLETIN 102-0157
FEB 2008

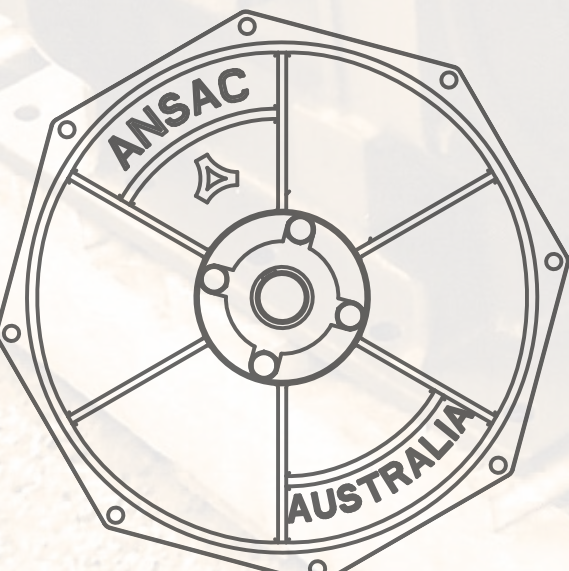
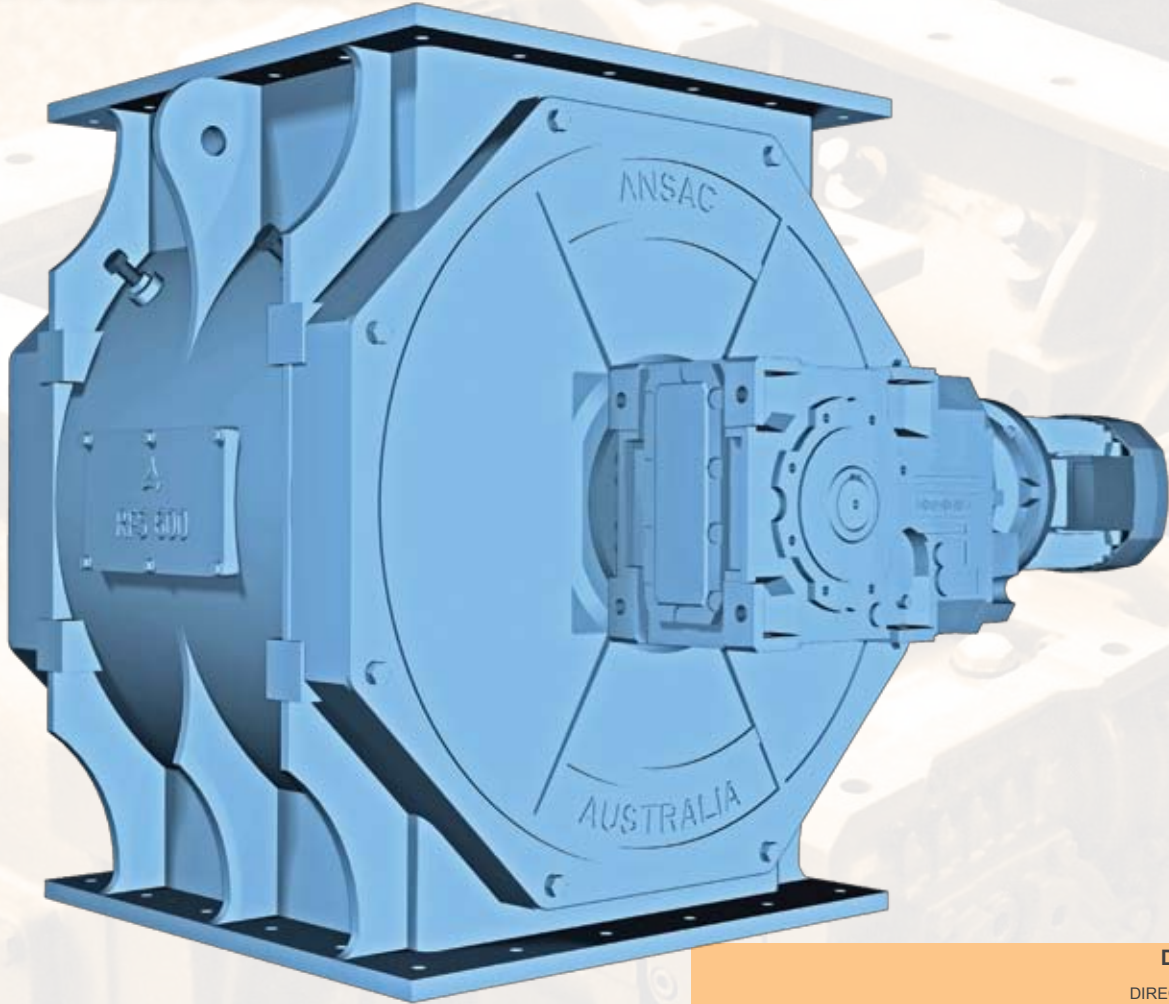

DRIVE TYPE

- DIRECT DRIVE : D
- *CHAIN DRIVE : C
- *BARE SHAFT : B

ROTOR SPEED

SEALING

- ANSAC STANDARD : -
- *GREASE PURGE : G
- *AIR PURGE : A

SURFACE TREATMENT

- ANSAC STANDARD : -
- *HIGH TEMPERATURE : H
- *COLOUR SPECIAL : C

UNDERSPEED SENSORS

- NONE : -
- SENSOR : S

RFS600 **D** **2.6** - - -

BASIC DESIGNATION

EXTENDED DESIGNATION

*OPTIONAL

DIRECT DRIVE > DIMENSIONS

RFS600

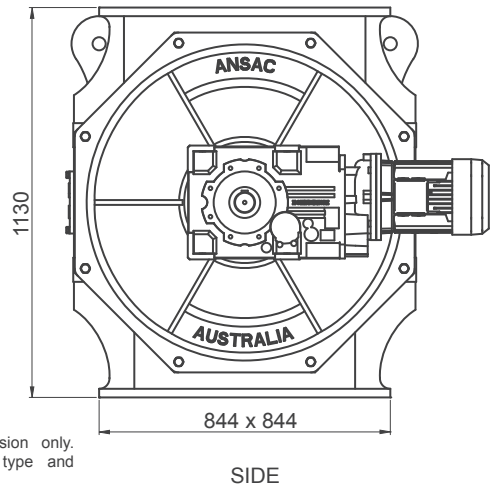
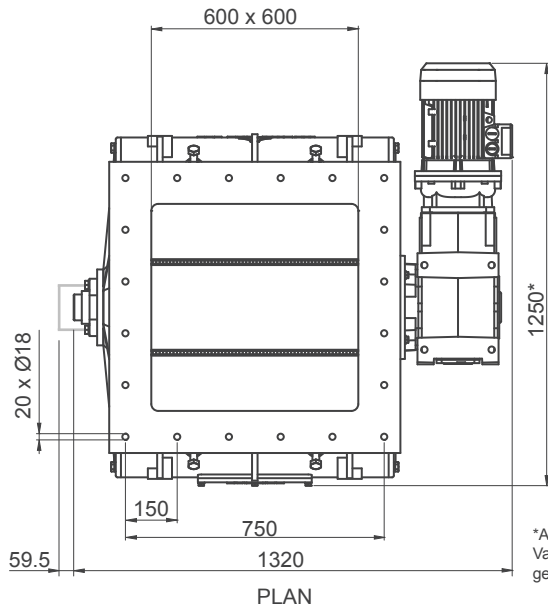

*Approximate dimension only. Varies with motor type and gearbox variation.

CHAIN DRIVE / BARE SHAFT > DIMENSIONS

RFS600

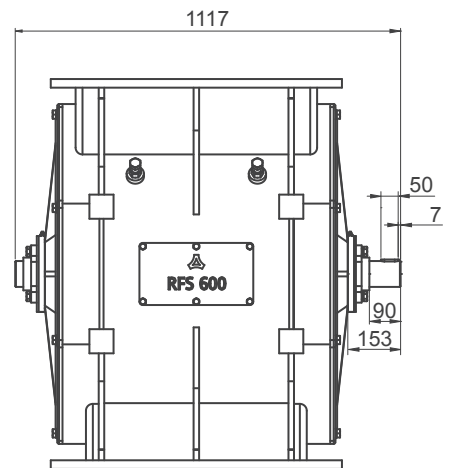
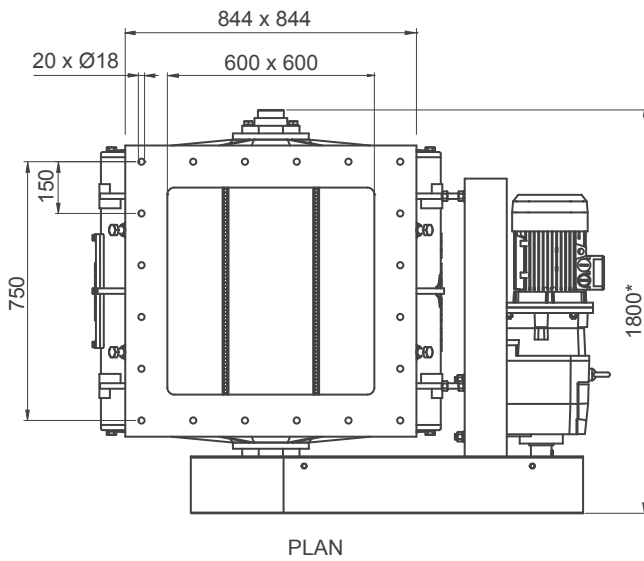

*Approximate dimension only. Varies with motor type and gearbox variation.

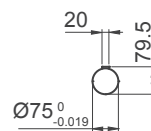
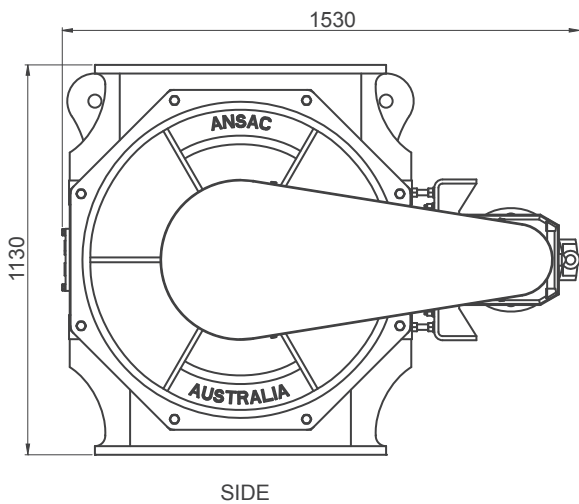

DRIVEN SHAFT SECTION (BARE SHAFT)

GEARBOX & MOTOR DATA

RFS600

RFS600D (DIRECT DRIVE)										
ROTOR SPEED (RPM)	1.0	2.6	4.9	6.2	7.5	9.0	10.5	11.4	14.1	17.6
CAPACITY (m ³ /hr)	19.9	51.8	97.6	123.5	149.4	179.3	209.2	227.1	280.9	350.6
GEARBOX	A604	A604	A604	A603	A603	A603	A603	A603	A603	A603
PART No.	101-9263	101-9264	101-6265	101-9266	101-9267	101-9268	101-9269	101-9013	101-9270	
MOTOR (kW)	0.75	1.5	2.2	3.0	3.0	4.0	4.0	4.0	5.5	
PART No.	100-6367	100-6369	100-6370	100-6371	100-6371	100-6372	100-6372	100-6372	100-6375	
RFS600C (CHAIN DRIVE)										
ROTOR SPEED (RPM)	1.0	2.5	4.8	5.9	7.0	8.6	10.9	11.7	13.6	17.5
CAPACITY (m ³ /hr)	19.9	50.5	95.9	117.7	138.6	170.8	216.1	233.6	270.2	348.6
GEARBOX	C703P	C703P	C703P	C703P	C703P	C703P	C703P	C703P	C703P	C702P
PART No.	101-9271	101-9272	101-9273	101-9274	101-9275	101-9276	101-9277	101-8902	101-9278	
MOTOR (kW)	1.5	3.0	3.0	4.0	4.0	5.5	5.5	7.5	7.5	
PART No.	100-6369	100-6371	100-6371	100-6372	100-6372	100-6375	100-6375	100-6376	100-6376	
1st SPROCKET, 3/4" PITCH	21	21	21	21	21	21	21	21	21	
2nd SPROCKET, 3/4" PITCH	48	48	48	48	48	48	48	48	48	

SHAFT SEALING

RFS600

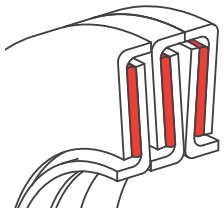

ANSAC STANDARD

Triple labyrinth 'Zed Seals' fitted with flock pads, and greased on each side of the valve, are standard with all RFS valves.

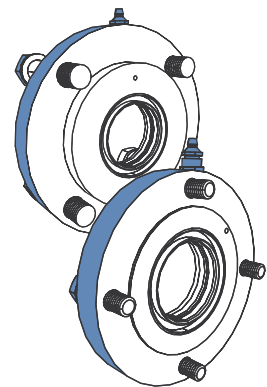

PURGE SEALING

Grease Purge - For extreme duty, valves can be fitted with a grease purge unit over the labyrinth seal. By creating a grease filled cavity between the seals, it prevents the escape of any dust particles or gases.

Air Purge - When grease cannot be used, air or other gases can be used to purge the seal so all dust particles or product gases are flushed back into the product stream.

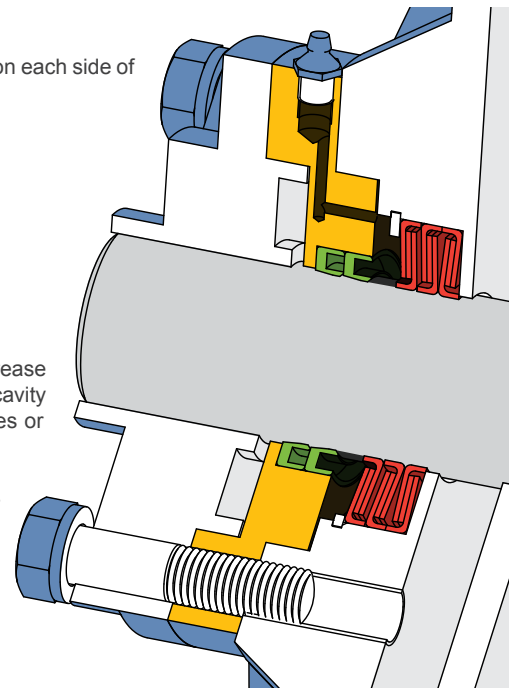

TYPICAL PURGE SEALING ARRANGEMENT

PROXIMITY SENSORS

RFS600

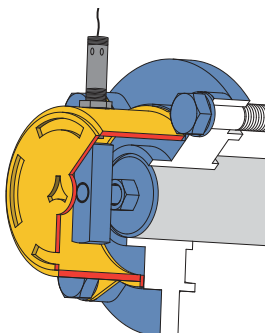

Underspeed sensors can be supplied and fitted to RFS valves. These are mounted on a specifically designed bracket that is bolted onto the bearing. The sensor fitted is 12mm in diameter with CD-PNP electrical connection and protection to IP67. The unit is suitable for temperatures from -25°C to +70°C.

CONSTRUCTION / TECHNICAL SPECIFICATIONS

RFS600

BODY	: Cast Iron	BEARINGS	: Cartridge Type
SHOE	: Hardened SG Iron	SHAFT	: CS1030
ROTOR	: SG Iron / Ceramic Tipped	SURFACE TREATMENT (ANSAC STANDARD)	: 50µm Grey Primer : 50µm Paracryl IFC (B53 Dk. Grey Blue w/ Y14 Golden Yellow for guards.)
SIDE PLATES	: Cast Iron	SURFACE TREATMENT (HIGH TEMPRATURE)	: 75µm ES600 Zinc Silicate Primer : 40µm Heatkote Aluminium
GEARBOX	: Direct Drive - Worm Drive / Direct Mounted : Chain Drive - In-line Helical		
SEALS	: Labrynth Type 'Zed' Seals		
SPECIAL SEALS	: Grease Purge : Air Purge		

ROTOR SPEED / CAPACITY

RFS600

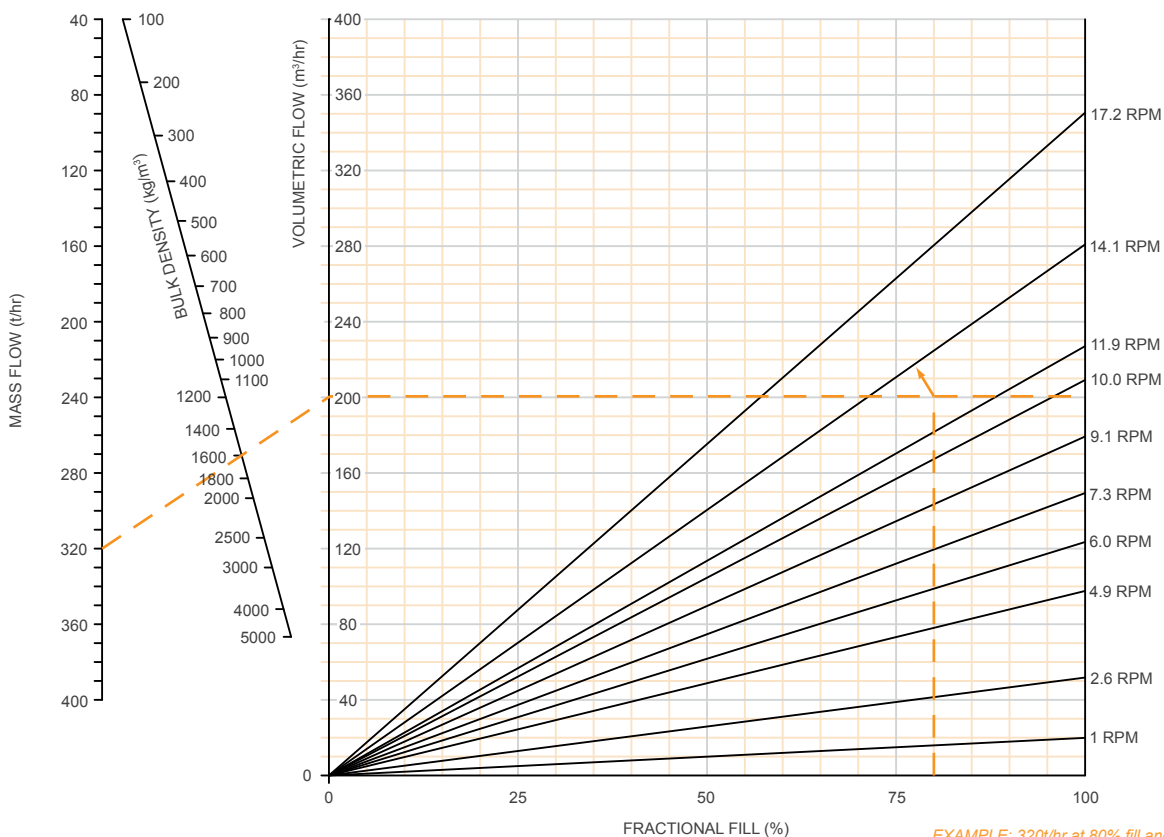

*EXAMPLE: 320t/hr at 80% fill and BD 1600kg/m³.
This equates to 200m³/hr and requires 14.1 RPM.*



ANSAC PTY LTD
ABN: 88 009 301 731

PO BOX 484, BUNBURY
LOT 2 ESTUARY DRIVE, BUNBURY
WESTERN AUSTRALIA 6231

PH: +61 8 97249000
FX: +61 8 97249010
E-mail: info@ansac.com.au

